

GENERAL REQUIREMENTS FOR TPDES STORM WATER QUALITY

OBTAIN "TEXAS COMMISSION ON ENVIRONMENTAL QUALITY" (TCEQ) CONSTRUCTION GENERAL PERMIT (PERMIT NO. TXR150000)

PREPARE AND SUBMIT A COPY OF "NOTICE OF INTENT" (NOI) TO TCEQ USING TCEQ'S FORM AT LEAST TWO (2) DAYS PRIOR TO COMMENCEMENT OF ANY CONSTRUCTION ACTIVITIES. PREPARE AND SUBMIT A COPY OF "NOTICE OF TERMINATION" (NOT) TO TCEQ AT THE END OF CONSTRUCTION OR AFTER THE SITE HAS REACHED FINAL STABILIZATION.

DEVELOPE AND IMPLEMENT A "STORM WATER POLLUTION PREVENTION PLAN: (SW3P)" PRIOR TO COMMENCEMENT OF ANY CONSTRUCTION ACTIVITIES.

"NOI" NEEDS TO BE POSTED AT THE CONSTRUCTION SITE IN LIEU OF A "CONSTRUCTION SITE NOTICE".

PAY APPLICABLE FEES TO TCEQ.

NOTIFY TCEQ AT LEAST TWO (2) DAYS PRIOR TO COMMENCEMENT OF ANY CONSTRUCTION ACTIVITIES.

NOTES:

1. EXECUTION AND CONSTRUCTION METHODS FOR STORM WATER POLLUTION PREVENTION PLAN SHALL BE IN CONFORMANCE WITH THE "STORM WATER MANAGEMENT HANDBOOK FOR CONSTRUCTION ACTIVITIES" BY CITY OF HOUSTON.
2. CONTRACTOR SHALL PROVIDE STABILIZED CONSTRUCTION EXIT AT A LOCATION APPROVED BY OWNER. THE MINIMUM SIZE REQUIRED TO KEEP STREET CLEAN AND FREE OF MUD CARRIED BY CONSTRUCTION VEHICLES SHALL BE UTILIZED.
3. SEDIMENT CONTROL DEVICES SHALL BE INSTALLED PRIOR TO DISTURBING UPSTREAM AREAS AND SHALL REMAIN UNTIL PERMANENT SOIL STABILIZATION/COVER IS IN PLACE.
4. CONTRACTOR SHALL PROTECT ALL STORM SEWER INLETS WITH INLET PROTECTION BARRIER (IPB).
5. STORM SEWER INLETS NOT REQUIRED TO MAINTAIN DRAINAGE MAY BE TEMPORARILY CAPPED.

FLOOD NOTE:

SUBJECT TRACT IS LOCATED IN ZONE "X" AREAS DETERMINED TO BE OUTSIDE THE 0.20% ANNUAL CHANCE FLOOD PER FEMA MAP 48157C0105 L DATED 04/02/14.

BENCHMARK:

SQUARE CUT ON TOP OF "C" INLET LOCATED NEAR THE NORTHEAST CORNER OF THE SUBJECT TRACT AND ON THE SOUTH R.O.W. LINE OF CROSS CREEK BEND LANE AS SHOWN ON SURVEY.
ELEV. = 134.76'

ELEVATIONS HEREON ARE BASED ON CROSS CREEK RANCH T.B.M. DISK NO. 1
ELEV. = 138.04', NAVD 88, 2001 ADJUSTMENT.

LEGEND

- ⊗-FF-⊗ FILTER FABRIC FENCE, MINIMUM 2 FEET BEHIND CURB
- ⊗-SC-⊗ STABILIZED CONSTRUCTION ACCESS/EXIT
- ⊗-IPB-⊗ INLET PROTECTION BARRIER
- PROPOSED TYPE "A" INLET

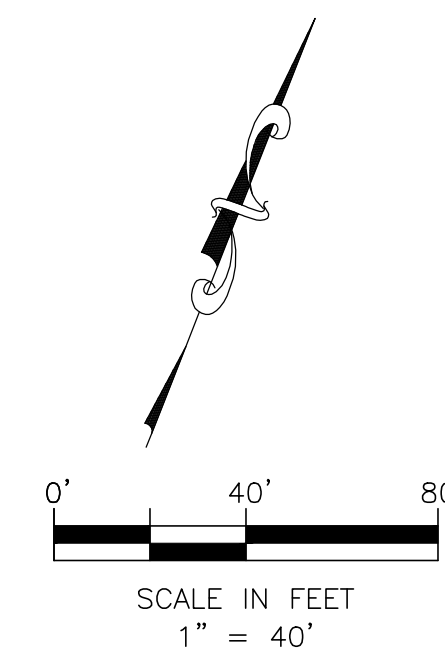

REVISIONS AND ISSUANCE		
NO.	DATE	DESCRIPTION

IVY KIDS EARLY LEARNING CENTER
 LOT COM21
 CROSS CREEK RANCH
 6407 CROSS CREEK BEND LANE
 FULSHEAR, Tx 77441

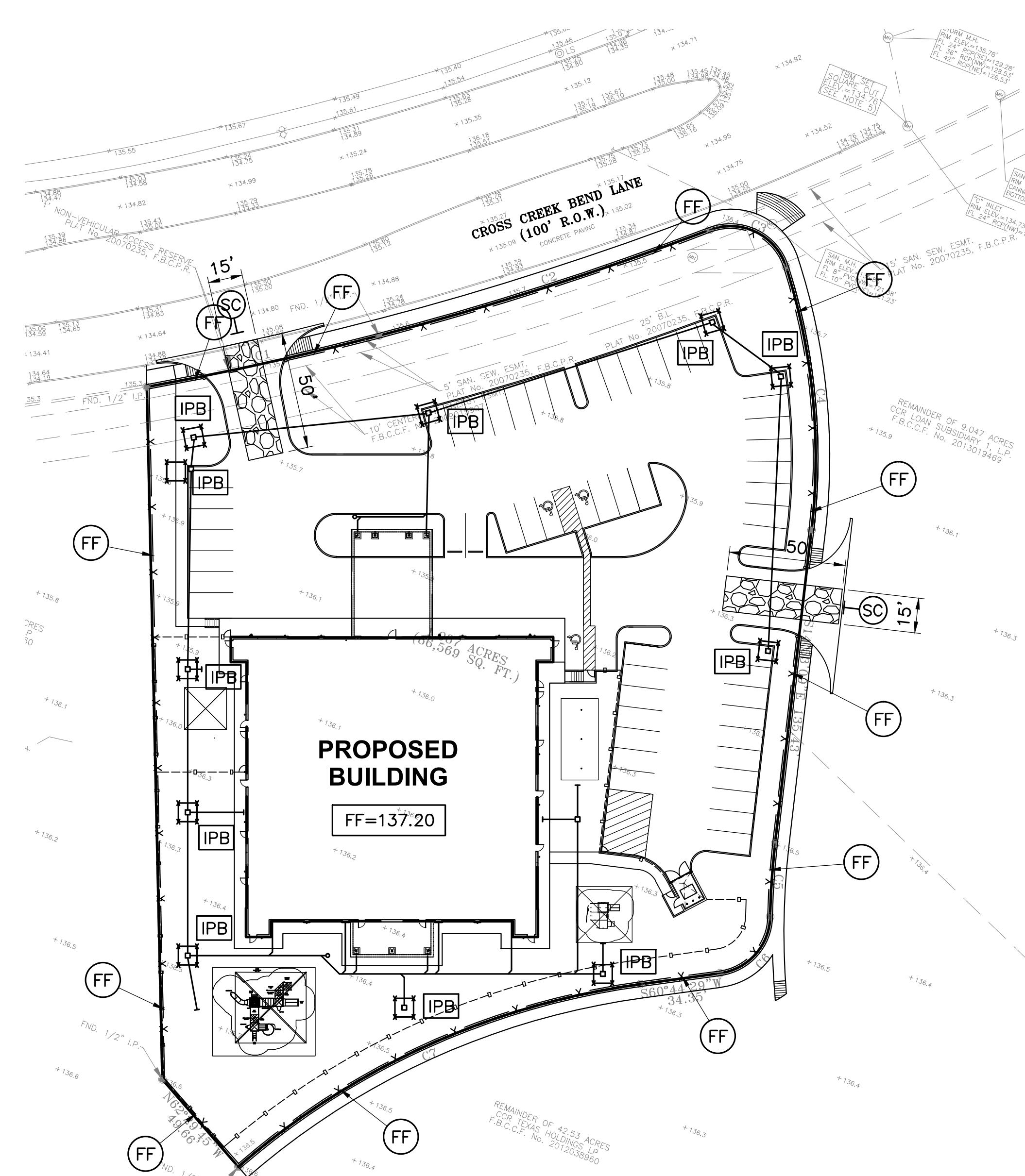
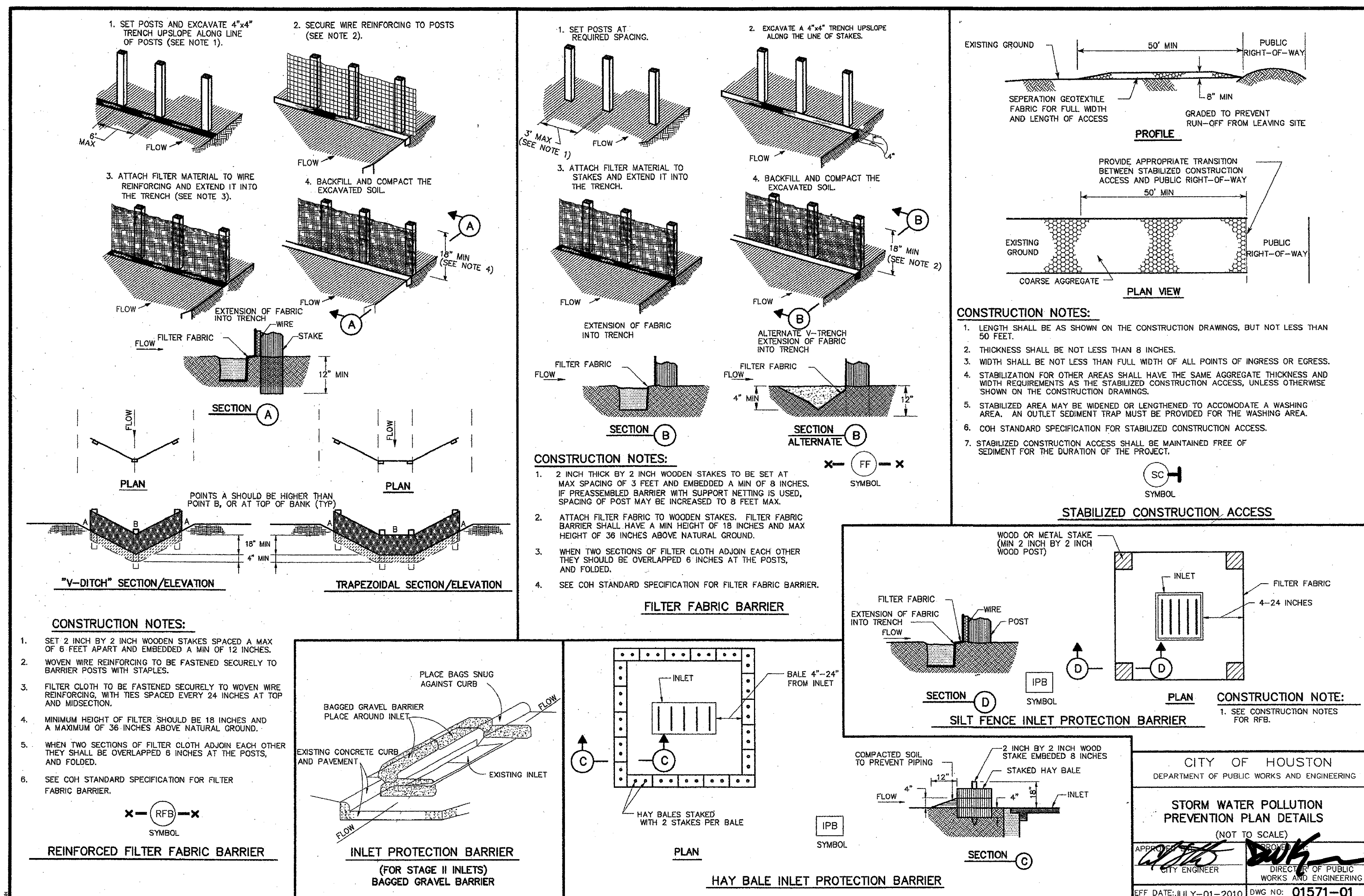

- CONSTRUCTION NOTES:**
1. LENGTH SHALL BE AS SHOWN ON THE CONSTRUCTION DRAWINGS, BUT NOT LESS THAN 50 FEET.
 2. THICKNESS SHALL BE NOT LESS THAN 8 INCHES.
 3. WIDTH SHALL BE NOT LESS THAN FULL WIDTH OF ALL POINTS OF INGRESS OR EGRESS.
 4. STABILIZATION FOR OTHER AREAS SHALL HAVE THE SAME AGGREGATE THICKNESS AND WIDTH REQUIREMENTS AS THE STABILIZED CONSTRUCTION ACCESS, UNLESS OTHERWISE SHOWN ON THE CONSTRUCTION DRAWINGS.
 5. STABILIZED AREA MAY BE WIDENED OR LENGTHENED TO ACCOMMODATE A WASHING AREA. AN OUTLET SEDIMENT TRAP MUST BE PROVIDED FOR THE WASHING AREA.
 6. COH STANDARD SPECIFICATION FOR STABILIZED CONSTRUCTION ACCESS.
 7. STABILIZED CONSTRUCTION ACCESS SHALL BE MAINTAINED FREE OF SEDIMENT FOR THE DURATION OF THE PROJECT.

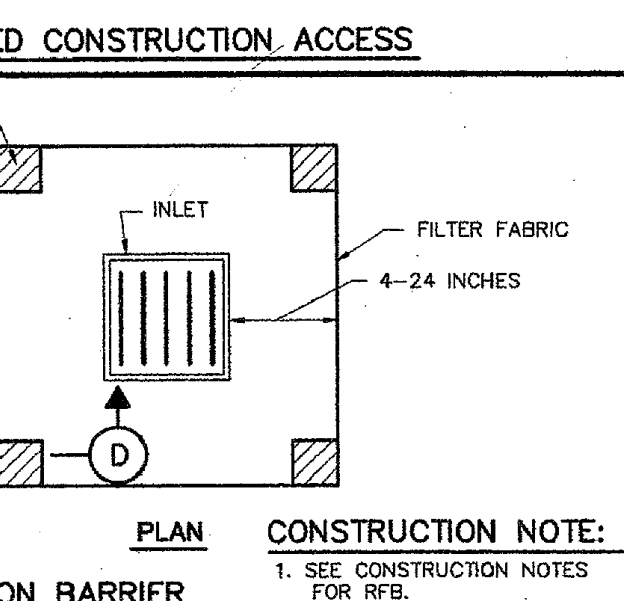

CITY OF HOUSTON
 DEPARTMENT OF PUBLIC WORKS AND ENGINEERING
STORM WATER POLLUTION PREVENTION PLAN DETAILS
 (NOT TO SCALE)
 APPROVED: [Signature] CITY ENGINEER
 DIRECTOR OF PUBLIC WORKS AND ENGINEERING
 EFF DATE: JULY-01-2010 DWG NO: 01571-01

MISSION ENGINEERING INC.
 10370 RICHMOND AVE, #560
 HOUSTON, TEXAS 77042
 (713) 981-0018
 [E] dzhuang@missioneng.com
 TPEF Registration No. F-11771

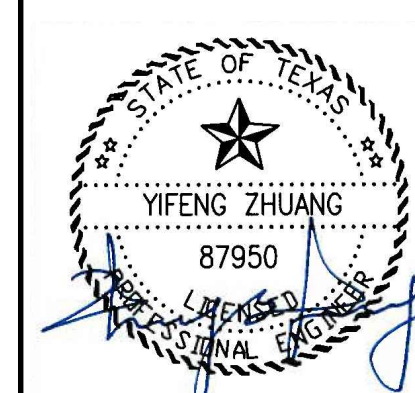

DRAWING TITLE	
SWPPP & DETAIL	
DRAWN BY	CHECKED BY
DATE	JOB NO.
DRAWING NO.	

C6